

REPORT OF GROUP DIRECTOR, NEIGHBOURHOODS AND HOUSING		
LICENSING SUB-COMMITTEE: 14/09/2021	Classification DECISION	Enclosure
Application for a Premises Licence Cricket, Railway Arches 369 and 370 Helmsley Place E8 3SB	Ward(s) affected London Fields	

1. SUMMARY

Applicant(s) Cricket Delivery Limited	In SPA: N/A
Date of Application 14/06/2021	Period of Application Permanent
Proposed licensable activity Late Night Refreshment Supply of Alcohol (On and Off Premises)	
Proposed hours of licensable activities	
Late Night Refreshment	Standard Hours: Fri 23:00-00:00 Sat 23:00-00:00
Supply of Alcohol	Standard Hours: Mon 08:00-23:00 Tue 08:00-23:00 Wed 08:00-23:00 Thu 08:00-23:00 Fri 08:00-00:00 Sat 08:00-00:00 Sun 08:00-23:00

The opening hours of the premises	
<p style="text-align: right;">Standard Hours: Mon 08:00-23:30 Tue 08:00-23:30 Wed 08:00-23:30 Thu 08:00-23:30 Fri 08:00-00:30 Sat 08:00-00:30 Sun 08:00-23:30</p>	
Capacity: Not known	
Policies Applicable	LP1 (General Principles), LP2 (Licensing Objectives), LP4 ('Off' Sales of Alcohol), LP6(External Areas and Outdoor Events) and LP11(Cumulative Impact – General)
List of Appendices	A – Application for a premises licence and supporting documents B – Representations from Responsible Authorities C – Location map
Relevant Representations	<ul style="list-style-type: none"> ● Police Authority ● Licensing Authority

2. APPLICATION

2.1 Cricket Delivery Limited have made an application for a premises licence under the Licensing Act 2003:

- To authorise the supply alcohol for consumption on and off the premises
- To provide late night refreshment

2.2 The application is attached as Appendix A.

3. CURRENT STATUS / HISTORY

3.1 The premises are not currently licensed for any activity.

4. REPRESENTATIONS: RESPONSIBLE AUTHORITIES

From	Details
Environmental Health Authority (Environmental Protection)	No representation received
Environmental Health Authority (Environmental Enforcement)	Representation withdrawn following agreed conditions as set out in para 8.1
Environmental Health Authority (Health & Safety)	No representation received

Weights and Measures (Trading Standards)	No representation received
Planning Authority	No representation received
Area Child Protection Officer	No representation received
Fire Authority	Have confirmed no representation on this application
Police Appendix B1	Representation received on the grounds of The Prevention of Crime and Disorder and the Prevention of Public Nuisance
Licensing Authority Appendix B2	Representation received on the grounds of The Prevention of Public Nuisance
Health Authority	No representation received

5. REPRESENTATIONS: OTHER PERSONS

From	Details
Representations received from and on behalf of local residents.	None.

6. GUIDANCE CONSIDERATIONS

- 6.1 The Licensing Authority is required to have regard to any guidance issued by the Secretary of State under the Licensing Act 2003.

7. POLICY CONSIDERATIONS

- 7.1 The Licensing Sub-Committee is required to have regard to the London Borough of Hackney's Statement of Licensing Policy ("the Policy") adopted by the Licensing Authority.
- 7.2 The Policy applies to applications where relevant representations have been made. With regard to this application, policies, LP1 (General Principles), LP2 (Licensing Objectives), LP4 ('Off' Sales of Alcohol), LP6(External Areas and Outdoor Events) and LP11(Cumulative Impact – General) are relevant.

8. OFFICER OBSERVATIONS

- 8.1 If the Sub-Committee is minded to approve the application, the following conditions should be applied to the licence:

Supply Of Alcohol (On/Both)

- 1.No supply of alcohol may be made under the premises licence:
- (a) At a time when there is no designated premises supervisor in respect of the premises licence.
 - (b) At a time when the designated premises supervisor does not hold a personal licence or his personal licence is suspended.

2. Every supply of alcohol under the premises licence must be made or authorised by a person who holds a personal licence.
3. (1) The responsible person must ensure that staff on relevant premises do not carry out, arrange or participate in any irresponsible promotions in relation to the premises.

(2) In this paragraph, an irresponsible promotion means any one or more of the following activities, or substantially similar activities, carried on for the purpose of encouraging the sale or supply of alcohol for consumption on the premises -
 - (a) games or other activities which require or encourage, or are designed to require or encourage, individuals to;
 - (i) drink a quantity of alcohol within a time limit (other than to drink alcohol sold or supplied on the premises before the cessation of the period in which the responsible person is authorised to sell or supply alcohol), or
 - (ii) drink as much alcohol as possible (whether within a time limit or otherwise);
 - (b) provision of unlimited or unspecified quantities of alcohol free or for a fixed or discounted fee to the public or to a group defined by a particular characteristic in a manner which carries a significant risk of undermining a licensing objective;
 - (c) provision of free or discounted alcohol or any other thing as a prize to encourage or reward the purchase and consumption of alcohol over a period of 24 hours or less in a manner which carries a significant risk of undermining a licensing objective;
 - (d) selling or supplying alcohol in association with promotional posters or flyers on, or in the vicinity of, the premises which can reasonably be considered to condone, encourage or glamorise anti-social behaviour or to refer to the effects of drunkenness in any favourable manner.
 - (e) dispensing alcohol directly by one person into the mouth of another (other than where that other person is unable to drink without assistance by reason of a disability).
4. The responsible person must ensure that free potable water is provided on request to customers where it is reasonably available.
5. 5.1. The premises licence holder or club premises certificate holder must ensure that an age verification policy is adopted in respect of the premises in relation to the sales or supply of alcohol.
5.2 The designated premises supervisor in relation to the premises licences must ensure that the supply of alcohol at the premises is carried on in accordance with the age verification policy.
5.3 The policy must require individuals who appear to the responsible person to be under 18 years of age (or such older age as may be specified in the policy) to produce on request, before being served alcohol, identification bearing their photograph, date of birth and either:-

- A. a holographic mark or
- B. an ultraviolet feature.

6. The responsible person shall ensure that:

a) where any of the following alcoholic drinks is sold or supplied for consumption on the premises (other than alcoholic drinks sold or supplied having been made up in advance ready for sale or supply in a securely closed container) it is available to customers in the following measures:

- beer or cider: 1/2 pint;
- gin, rum, vodka or whisky: 25ml or 35ml; and
- still wine in a glass: 125ml; and

a. these measures are displayed in a menu, price list or other printed material which is available to customers on the premises; and

b. where a customer does not in relation to a sale of alcohol specify the quantity of alcohol to be sold, the customer is made aware that these measures are available.

Minimum Drinks Pricing

7. 7.1 A relevant person shall ensure that no alcohol is sold or supplied for consumption on or off the premises for a price which is less than the permitted price.

7.2 For the purposes of the condition set out in paragraph 7.1 above -

(a) "duty" is to be construed in accordance with the Alcoholic Liquor Duties Act 1979;

(i) "permitted price" is the price found by applying the formula - $P = D + (D \times V)$ Where -P is the permitted price,

(ii) D is the amount of duty chargeable in relation to the alcohol as if the duty were charged on the date of the sale or supply of the alcohol, and

(iii) V is the rate of value added tax chargeable in relation to the alcohol as if the value added tax were charged on the date of the sale or supply of the alcohol;

(b) "relevant person" means, in relation to premises in respect of which there is in force a premises licence -

(i) the holder of the premises licence,

(ii) the designated premises supervisor (if any) in respect of such a licence, or

(iii) the personal licence holder who makes or authorises a supply of alcohol under such a licence;

(c) "relevant person" means, in relation to premises in respect of which there is in force a club premises certificate, any member or officer of the club present on the premises in a capacity which enables the member or officer to prevent the supply in question; and

(d) "value added tax" means value added tax charged in accordance with the Value Added Tax Act 1994.

7.3 Where the permitted price given by Paragraph 8.2(b) above would (apart from this paragraph) not be a whole number of pennies, the price given by that sub-paragraph shall be taken to be the price actually given by that sub-paragraph rounded up to the nearest penny.

7.4 (1) Sub-paragraph 7.4(2) below applies where the permitted price given by Paragraph 7.2(b) above on a day (“the first day”) would be different from the permitted price on the next day (“the second day”) as a result of a change to the rate of duty or value added tax.

(2) The permitted price which would apply on the first day applies to sales or supplies of alcohol which take place before the expiry of the period of 14 days beginning on the second day.

Door Supervision

8. Each individual who is to carry out a security activity at the premises must be licensed by the Security Industry Authority.

Conditions derived from operating schedule

9. The requirement for SIA registered supervisors to be employed at the premises shall be subject to an ongoing risk assessment by the premises licence holder. Where required, SIA registered door supervisors will be employed in accordance with the risk assessment.

10. The premises shall install and maintain a comprehensive CCTV system as per the minimum requirements of the Hackney Police Licensing Team. All entry and exit points will be covered enabling frontal identification of every person entering in any light condition. The CCTV system shall continually record whilst the premises is open for licensable activities and during all times when customers remain on the premises. All recordings shall be stored for a minimum period of 31 days with date and time stamping. Viewing of recordings shall be made available immediately upon the request of the Police or authorised officer throughout the preceding 31 day period.

11. A staff member from the premises who is conversant with the operation of the CCTV system shall be on the premises at all times when the premises is open. This staff member must be able to provide a Police or authorised council officer copies of recent CCTV images or data with the absolute minimum of delay when requested.

12. The licensee shall display the telephone number/email address of the Designated Premises Supervisor for use by any Responsible Authority or any person who may wish to make a complaint during the operation of the licence in a prominent external location at the premises that is easily accessible to the public.

13. There shall be a written dispersal policy in a form agreed with the Police and Licensing Authority, a copy of which shall be kept on the premises and produced to Police or an authorised officer upon request.

14. Patrons permitted to temporarily leave and then re-enter the premises, e.g. to smoke, shall not be permitted to take alcoholic drinks with them.

15. An incident log shall be kept at the premises, and made available on request to an authorised officer of the City Council or the Police, which will record the following:

- a. all crimes reported to the venue;
- b. all ejections of patrons;
- c. any complaints received concerning crime and disorder;
- d. any incidents of disorder;
- e. all seizures of drugs or offensive weapons;
- f. any faults in the CCTV system or searching equipment or scanning equipment;
- g. any refusal of the sale of alcohol; and
- h. any visit by a relevant authority or emergency service.

16. Notices shall be displayed at the exit of the premises requesting customers to leave the premises to respect the needs of local residents and businesses and leave the area quietly.

17. A Challenge 25 proof of age scheme shall be operated at the premises where the only acceptable forms of identification are recognised photographic identification cards, such as a driving licence, passport or proof of age card with the PASS Hologram.

18. No deliveries to the premises shall take place between 23.00 and 07.00 on the following day.

19. All waste shall be properly presented and placed out for collection no earlier than 30 minutes before the scheduled collection times.

20. No noise generated on the premises, or by its associated plant or equipment, shall emanate from the premises nor vibration be transmitted through the structure of the premises which gives rise to a nuisance.

Conditions derived from Responsible Authority representations

21. The Licensee shall ensure that all staff are fully trained and made aware of the legal requirement of businesses to comply with their responsibility as regards the disposal of waste produced from the business premises. The procedure for handling and preparing for disposal of the waste shall be in writing and displayed in a prominent place where it can be referred to at all times by staff.

22. The Licensee shall ensure that any contract for general and recyclable waste disposal shall be appropriate in size to the amount of waste produced by the business. The Licensee shall maintain an adequate supply of waste receptacles provided by his registered waste carrier (refuse sacks or commercial waste bins) in order to ensure all refuse emanating from the business is always presented for collection by his waste carrier and shall not use any plain black or unidentifiable refuse sacks or any other unidentifiable or unmarked waste receptacles.

23. The Licensee's premises are situated in an area within which refuse may only be left on the public highway at certain times (time bands). If the Licensee's waste carrier cannot or does not comply by collecting the refuse within an hour after the close of any time band imposed by the waste authority, the Licensee must remove the refuse from the public highway and/or keep it within the premises until such time as his/her waste carrier arrives to collect the refuse.

24. The Licensee shall instruct members of staff to make regular checks of the area immediately outside the premises and remove any litter, bottles and glasses emanating from the premises. A final check should be made at close of business.

25. The Licensee shall provide a safe receptacle for cigarette ends to be placed outside for the use of customers, such receptacles being carefully placed so as not to cause an obstruction or trip.

26. The current trade waste agreement/duty of care waste transfer document shall be conspicuously displayed and maintained in the window of the premises where it can be conveniently seen and read. This should remain unobstructed at all times and should clearly identify:-

- the name of the registered waste carrier
- the date of commencement of trade waste contract the date of expiry of trade waste contract
- the days and times of collection
- the type of waste including the European Waste Code

9. REASONS FOR OFFICER OBSERVATIONS

9.1 Conditions 9 to 20 are derived from the applicant's operating schedule. Conditions 21 to 26 are proposed by the Environmental Enforcement. The applicant has agreed to the proposed conditions.

10. LEGAL COMMENTS

10.1 The Council has a duty as a Licensing Authority under the Licensing Act 2003 to carry out its functions with a view to promoting the following 4 licensing objectives;

- The Prevention of Crime and Disorder
- Public Safety
- Prevention of Public Nuisance
- The Protection of Children from Harm

10.2 It should be noted that each of the licensing objectives have equal importance and are the only grounds upon which a relevant representation can be made and for which an application can be refused or terms and conditions attached to a licence.

11. HUMAN RIGHTS ACT 1998 IMPLICATIONS

11.1 There are implications to;

- **Article 6** – Right to a fair hearing
- **Article 14** – Not to discriminate
- Balancing: **Article 1**- Peaceful enjoyment of their possession (i.e. a licence is defined as being a possession) with **Article 8** – Right of Privacy (i.e. respect private & family life) to achieve a proportionate decision having regard to the protection of an individuals rights against the interests of the community at large.

12. MEMBERS DECISION MAKING

A. Option 1

That the application be refused

B. Option 2

That the application be approved, together with any conditions or restrictions which Members consider necessary for the promotion of the Licensing objectives.

13. CONCLUSION

13.1 That Members decide on the application under the Licensing Act 2003.

Group Director, Neighbourhoods and Housing	Ajman Ali
Lead Officer (holder of original copy):	Sanaria Hussain Senior Licensing Officer Licensing Service 1 Hillman Street E8 1DY Telephone: 020 8356 2431

LIST OF BACKGROUND PAPERS RELATING TO THIS REPORT

The following document(s) has been relied upon in the preparation of the report.

Description of document	Location
Kricket, Railway Arches 369 and 370 Helmsley Place E8 3SB	Licensing Service 1 Hillman Street London E8 1DY

Printed matter

Licensing Act 2003

LBH Statement of Licensing Policy

Application for a premises licence to be granted under the Licensing Act 2003

PLEASE READ THE FOLLOWING INSTRUCTIONS FIRST

Before completing this form please read the guidance notes at the end of the form. If you are completing this form by hand please write legibly in block capitals. In all cases ensure that your answers are inside the boxes and written in black ink. Use additional sheets if necessary.

You may wish to keep a copy of the completed form for your records.

APPENDIX A

I/We **Kricket Delivery Limited**

(Insert name(s) of applicant)

apply for a premises licence under section 17 of the Licensing Act 2003 for the premises described in Part 1 below (the premises) and I/we are making this application to you as the relevant licensing authority in accordance with section 12 of the Licensing Act 2003

Part 1 – Premises details

Postal address of premises or, if none, ordnance survey map reference or description Kricket Delivery Arches 369+370 Helmsley Place			
Post town	London	Postcode	E8 3SB

Telephone number at premises (if any)	
Non-domestic rateable value of premises	£32000

Part 2 - Applicant details

Please state whether you are applying for a premises licence as

Please tick as appropriate

- | | | |
|--|-------------------------------------|-----------------------------|
| a) an individual or individuals * | <input type="checkbox"/> | please complete section (A) |
| b) a person other than an individual * | | |
| i as a limited company/limited liability partnership | <input checked="" type="checkbox"/> | please complete section (B) |
| ii as a partnership (other than limited liability) | <input type="checkbox"/> | please complete section (B) |
| iii as an unincorporated association or | <input type="checkbox"/> | please complete section (B) |
| iv other (for example a statutory corporation) | <input type="checkbox"/> | please complete section (B) |
| c) a recognised club | <input type="checkbox"/> | please complete section (B) |
| d) a charity | <input type="checkbox"/> | please complete section (B) |
| e) the proprietor of an educational establishment | <input type="checkbox"/> | please complete section (B) |
| f) a health service body | <input type="checkbox"/> | please complete section (B) |

- g) a person who is registered under Part 2 of the Care Standards Act 2000 (c14) in respect of an independent hospital in Wales please complete section (B)
- ga) a person who is registered under Chapter 2 of Part 1 of the Health and Social Care Act 2008 (within the meaning of that Part) in an independent hospital in England please complete section (B)
- h) the chief officer of police of a police force in England and Wales please complete section (B)

* If you are applying as a person described in (a) or (b) please confirm (by ticking yes to one box below):

I am carrying on or proposing to carry on a business which involves the use of the premises for licensable activities; or

I am making the application pursuant to a
 statutory function or
 a function discharged by virtue of Her Majesty's prerogative

(A) INDIVIDUAL APPLICANTS (fill in as applicable)

Mr <input type="checkbox"/>	Mrs <input type="checkbox"/>	Miss <input type="checkbox"/>	Ms <input type="checkbox"/>	Other Title (for example, Rev)	
Surname			First names		
Date of birth		I am 18 years old or over <input type="checkbox"/>		Please tick yes	
Nationality					
Current residential address if different from premises address					
Post town				Postcode	
Daytime contact telephone number					
E-mail address (optional)					
Where applicable (if demonstrating a right to work via the Home Office online right to work checking service), the 9-digit 'share code' provided to the applicant by that service (please see note 15 for information)					

SECOND INDIVIDUAL APPLICANT (if applicable)

Mr <input type="checkbox"/>	Mrs <input type="checkbox"/>	Miss <input type="checkbox"/>	Ms <input type="checkbox"/>	Other Title (for example, Rev)	
Surname			First names		
Date of birth		I am 18 years old or over <input type="checkbox"/>		Please tick yes	
Nationality					
Where applicable (if demonstrating a right to work via the Home Office online right to work checking service), the 9-digit 'share code' provided to the applicant by that service: (please see note 15 for information)					

Current residential address if different from premises address			
Post town		Postcode	
Daytime contact telephone number			
E-mail address (optional)			

(B) OTHER APPLICANTS

Please provide name and registered address of applicant in full. Where appropriate please give any registered number. In the case of a partnership or other joint venture (other than a body corporate), please give the name and address of each party concerned.

Name Cricket Delivery Limited
Address Finsgate, 5-7 Cranwood Street, London, EC1V 9EE
Registered number (where applicable) 13214579
Description of applicant (for example, partnership, company, unincorporated association etc.) Private limited Company
Telephone number (if any)
E-mail address (optional)

Part 3 Operating Schedule

When do you want the premises licence to start?

DD	MM	YYYY
<input type="text"/>	<input type="text"/>	<input type="text"/>

If you wish the licence to be valid only for a limited period, when do you want it to end?

DD	MM	YYYY
<input type="text"/>	<input type="text"/>	<input type="text"/>

Please give a general description of the premises (please read guidance note 1)

The application proposes a single core hours premises licence to replace the current 2 x 01:45am premises licences reference 061486 and 061401 covering Arches 369 and 370 with updated licence conditions.

The premises will operate as a central kitchen and brewery storage facility, with an accompanying restaurant and bar facility in Arches 369 and 370 with external terrace.

If 5,000 or more people are expected to attend the premises at any one time, please state the number expected to attend.

What licensable activities do you intend to carry on from the premises?

(please see sections 1 and 14 and Schedules 1 and 2 to the Licensing Act 2003)

Provision of regulated entertainment (please read guidance note 2)

Please tick all that apply

- a) plays (if ticking yes, fill in box A)
- b) films (if ticking yes, fill in box B)
- c) indoor sporting events (if ticking yes, fill in box C)
- d) boxing or wrestling entertainment (if ticking yes, fill in box D)
- e) live music (if ticking yes, fill in box E)
- f) recorded music (if ticking yes, fill in box F)
- g) performances of dance (if ticking yes, fill in box G)
- h) anything of a similar description to that falling within (e), (f) or (g) (if ticking yes, fill in box H)

Provision of late night refreshment (if ticking yes, fill in box I)

Supply of alcohol (if ticking yes, fill in box J)

In all cases complete boxes K, L and M

A

Plays Standard days and timings (please read guidance note 7)			<u>Will the performance of a play take place indoors or outdoors or both – please tick</u> (please read guidance note 3)	Indoors <input type="checkbox"/>
				Outdoors <input type="checkbox"/>
				Both <input type="checkbox"/>
Day	Start	Finish	<u>Please give further details here</u> (please read guidance note 4)	
Mon				
Tue			<u>State any seasonal variations for performing plays</u> (please read guidance note 5)	
Wed				
Thur			<u>Non standard timings. Where you intend to use the premises for the performance of plays at different times to those listed in the column on the left, please list</u> (please read guidance note 6)	
Fri				
Sat				
Sun				

B

Films Standard days and timings (please read guidance note 7)			<u>Will the exhibition of films take place indoors or outdoors or both – please tick</u> (please read guidance note 3)	Indoors	<input type="checkbox"/>
				Outdoors	<input type="checkbox"/>
				Both	<input type="checkbox"/>
Day	Start	Finish	<u>Please give further details here</u> (please read guidance note 4)		
Mon					
			<u>State any seasonal variations for the exhibition of films</u> (please read guidance note 5)		
Tue					
			<u>Non standard timings. Where you intend to use the premises for the exhibition of films at different times to those listed in the column on the left, please list</u> (please read guidance note 6)		
Wed					
Thur					
Fri					
Sat					
Sun					

C

Indoor sporting events Standard days and timings (please read guidance note 7)			<u>Please give further details</u> (please read guidance note 4)
Day	Start	Finish	
Mon			
Tue			
Wed			
Thur			
Fri			
Sat			
Sun			
			<u>State any seasonal variations for indoor sporting events</u> (please read guidance note 5)
			<u>Non standard timings. Where you intend to use the premises for indoor sporting events at different times to those listed in the column on the left, please list</u> (please read guidance note 6)

D

Boxing or wrestling entertainments Standard days and timings (please read guidance note 7)			<u>Will the boxing or wrestling entertainment take place indoors or outdoors or both – please tick</u> (please read guidance note 3)	Indoors	<input type="checkbox"/>
				Outdoors	<input type="checkbox"/>
				Both	<input type="checkbox"/>
Day	Start	Finish	<u>Please give further details here</u> (please read guidance note 4)		
Mon					
Tue			<u>State any seasonal variations for boxing or wrestling entertainment</u> (please read guidance note 5)		
Wed					
Thur			<u>Non standard timings. Where you intend to use the premises for boxing or wrestling entertainment at different times to those listed in the column on the left, please list</u> (please read guidance note 6)		
Fri					
Sat					
Sun					

E

Live music Standard days and timings (please read guidance note 7)			<u>Will the performance of live music take place indoors or outdoors or both – please tick</u> (please read guidance note 3)	Indoors <input type="checkbox"/>
				Outdoors <input type="checkbox"/>
				Both <input type="checkbox"/>
Day	Start	Finish	<u>Please give further details here</u> (please read guidance note 4)	
Mon				
Tue				
Wed				
			<u>State any seasonal variations for the performance of live music</u> (please read guidance note 5)	
Thur				
			<u>Non standard timings. Where you intend to use the premises for the performance of live music at different times to those listed in the column on the left, please list</u> (please read guidance note 6)	
Fri				
Sat				
Sun				

F

Recorded music Standard days and timings (please read guidance note 7)			<u>Will the playing of recorded music take place indoors or outdoors or both – please tick</u> (please read guidance note 3)	Indoors <input type="checkbox"/>
				Outdoors <input type="checkbox"/>
				Both <input type="checkbox"/>
Day	Start	Finish	<u>Please give further details here</u> (please read guidance note 4)	
Mon				
Tue				
Wed				
			<u>State any seasonal variations for the playing of recorded music</u> (please read guidance note 5)	
Thur				
			<u>Non standard timings. Where you intend to use the premises for the playing of recorded music at different times to those listed in the column on the left, please list</u> (please read guidance note 6)	
Fri				
Sat				
Sun				

G

Performances of dance Standard days and timings (please read guidance note 7)			<u>Will the performance of dance take place indoors or outdoors or both – please tick</u> (please read guidance note 3)	Indoors	<input type="checkbox"/>
				Outdoors	<input type="checkbox"/>
				Both	<input type="checkbox"/>
Day	Start	Finish	<u>Please give further details here</u> (please read guidance note 4)		
Mon					
			<u>State any seasonal variations for the performance of dance</u> (please read guidance note 5)		
Tue					
			<u>Non standard timings. Where you intend to use the premises for the performance of dance at different times to those listed in the column on the left, please list</u> (please read guidance note 6)		
Wed					
Thur					
Fri					
Sat					
Sun					

H

Anything of a similar description to that falling within (e), (f) or (g) Standard days and timings (please read guidance note 7)			Please give a description of the type of entertainment you will be providing		
Day	Start	Finish	Will this entertainment take place indoors or outdoors or both – please tick (please read guidance note 3)	Indoors	<input type="checkbox"/>
Mon				Outdoors	<input type="checkbox"/>
				Both	<input type="checkbox"/>
Tue			Please give further details here (please read guidance note 4)		
Wed					
Thur			State any seasonal variations for entertainment of a similar description to that falling within (e), (f) or (g) (please read guidance note 5)		
Fri					
Sat			Non standard timings. Where you intend to use the premises for the entertainment of a similar description to that falling within (e), (f) or (g) at different times to those listed in the column on the left, please list (please read guidance note 6)		
Sun					

I

Late night refreshment Standard days and timings (please read guidance note 7)			Will the provision of late night refreshment take place indoors or outdoors or both – please tick (please read guidance note 3)	Indoors	<input checked="" type="checkbox"/>
				Outdoors	<input type="checkbox"/>
				Both	<input type="checkbox"/>
Day	Start	Finish	Please give further details here (please read guidance note 4)		
Mon					
Tue					
Wed			State any seasonal variations for the provision of late night refreshment (please read guidance note 5)		
Thur					
Fri	2300	0000			
Sat	2300	0000	Non standard timings. Where you intend to use the premises for the provision of late night refreshment at different times, to those listed in the column on the left, please list (please read guidance note 6)		
Sun					

J

Supply of alcohol Standard days and timings (please read guidance note 7)			<u>Will the supply of alcohol be for consumption – please tick</u> (please read guidance note 8)	On the premises	<input type="checkbox"/>
				Off the premises	<input type="checkbox"/>
				Both	<input checked="" type="checkbox"/>
Day	Start	Finish	<u>State any seasonal variations for the supply of alcohol</u> (please read guidance note 5)		
Mon	0800	2300			
Tue	0800	2300			
Wed	0800	2300			
Thur	0800	2300			
Fri	0800	0000			
Sat	0800	0000			
Sun	0800	2300			
			<u>Non standard timings. Where you intend to use the premises for the supply of alcohol at different times to those listed in the column on the left, please list</u> (please read guidance note 6)		

State the name and details of the individual whom you wish to specify on the licence as designated premises supervisor (Please see declaration about the entitlement to work in the checklist at the end of the form):

Name Richard Andrew Campbell	
Date of birth [REDACTED]	
Address [REDACTED] [REDACTED]	
Postcode	[REDACTED]
[REDACTED] [REDACTED]	
Issuing licensing authority (if known) London Borough of Hackney	

K

Please highlight any adult entertainment or services, activities, other entertainment or matters ancillary to the use of the premises that may give rise to concern in respect of children (please read guidance note 9).

None

L

Hours premises are open to the public Standard days and timings (please read guidance note 7)			State any seasonal variations (please read guidance note 5)
Day	Start	Finish	
Mon	0800	2330	Non standard timings. Where you intend the premises to be open to the public at different times from those listed in the column on the left, please list (please read guidance note 6)
Tue	0800	2330	
Wed	0800	2330	
Thur	0800	2330	
Fri	0800	0030	
Sat	0800	0030	
Sun	0800	2330	

M

Describe the steps you intend to take to promote the four licensing objectives:

a) General – all four licensing objectives (b, c, d and e) (please read guidance note 10)

Please refer to the attached schedule of conditions for the promotion of all four licensing objectives.

b) The prevention of crime and disorder

Please refer to a) above.

c) Public safety

Please refer to a) above.

d) The prevention of public nuisance

Please refer to a) above.

e) The protection of children from harm

Please refer to a) above.

Checklist:

Please tick to indicate agreement

- I have made or enclosed payment of the fee.
- I have enclosed the plan of the premises.
- I have sent copies of this application and the plan to responsible authorities and others where applicable (postal applications only) **[Electronic Submission - LA to serve RA's]**
- I have enclosed the consent form completed by the individual I wish to be designated premises supervisor, if applicable.
- I understand that I must now advertise my application.
- I understand that if I do not comply with the above requirements my application will be rejected.
[Applicable to all individual applicants, including those in a partnership which is not a limited liability partnership, but not companies or limited liability partnerships]
- I have included documents demonstrating my entitlement to work in the United Kingdom or my share code issued by the Home Office online right to work checking service (please read note 15).

IT IS AN OFFENCE, UNDER SECTION 158 OF THE LICENSING ACT 2003, TO MAKE A FALSE STATEMENT IN OR IN CONNECTION WITH THIS APPLICATION. THOSE WHO MAKE A FALSE STATEMENT MAY BE LIABLE ON SUMMARY CONVICTION TO A FINE OF ANY AMOUNT.

IT IS AN OFFENCE UNDER SECTION 24B OF THE IMMIGRATION ACT 1971 FOR A PERSON TO WORK WHEN THEY KNOW, OR HAVE REASONABLE CAUSE TO BELIEVE, THAT THEY ARE DISQUALIFIED FROM DOING SO BY REASON OF THEIR IMMIGRATION STATUS. THOSE WHO EMPLOY AN ADULT WITHOUT LEAVE OR WHO IS SUBJECT TO CONDITIONS AS TO EMPLOYMENT WILL BE LIABLE TO A CIVIL PENALTY UNDER SECTION 15 OF THE IMMIGRATION, ASYLUM AND NATIONALITY ACT 2006 AND PURSUANT TO SECTION 21 OF THE SAME ACT, WILL BE COMMITTING AN OFFENCE WHERE THEY DO SO IN THE KNOWLEDGE, OR WITH REASONABLE CAUSE TO BELIEVE, THAT THE EMPLOYEE IS DISQUALIFIED.

Part 4 – Signatures (please read guidance note 11)

Signature of applicant or applicant’s solicitor or other duly authorised agent (see guidance note 12). **If signing on behalf of the applicant, please state in what capacity.**

Declaration	<ul style="list-style-type: none"> • [Applicable to individual applicants only, including those in a partnership which is not a limited liability partnership] I understand I am not entitled to be issued with a licence if I do not have the entitlement to live and work in the UK (or if I am subject to a condition preventing me from doing work relating to the carrying on of a licensable activity) and that my licence will become invalid if I cease to be entitled to live and work in the UK (please read guidance note 15). • The DPS named in this application form is entitled to work in the UK (and is not subject to conditions preventing him or her from doing work relating to a licensable activity) and I have seen a copy of his or her proof of entitlement to work, or have conducted an online right to work check using the Home Office online right to work checking service which confirmed their right to work (please see note 15)
Signature	<i>Thomas and Thomas</i>
Date	14 June 2021
Capacity	Applicant's Solicitors

For joint applications, signature of 2nd applicant or 2nd applicant’s solicitor or other authorised agent (please read guidance note 13). If signing on behalf of the applicant, please state in what capacity.

Signature	
Date	
Capacity	

Contact name (where not previously given) and postal address for correspondence associated with this application (please read guidance note 14)			
[REDACTED]			
[REDACTED]			
[REDACTED]			
Post town	London	Postcode	[REDACTED]
Telephone number (if any)	[REDACTED]		
If you would prefer us to correspond with you by e-mail, your e-mail address (optional)			
[REDACTED]			

Notes for Guidance

- Describe the premises, for example the type of premises, its general situation and layout and any other information which could be relevant to the licensing objectives. Where your application includes off-supplies of alcohol and you intend to provide a place for consumption of these off-supplies, you must include a description of where the place will be and its proximity to the premises.
- In terms of specific regulated entertainments please note that:
 - Plays: no licence is required for performances between 08:00 and 23.00 on any day, provided that the audience does not exceed 500.
 - Films: no licence is required for ‘not-for-profit’ film exhibition held in community premises between 08.00 and 23.00 on any day provided that the audience does not exceed 500 and the organiser (a) gets consent to the screening from a person who is responsible for the premises; and (b) ensures that each such screening abides by age classification ratings.
 - Indoor sporting events: no licence is required for performances between 08.00 and 23.00 on any day, provided that the audience does not exceed 1000.
 - Boxing or Wrestling Entertainment: no licence is required for a contest, exhibition or display of Greco-Roman wrestling, or freestyle wrestling between 08.00 and 23.00 on any day, provided that the audience does not exceed 1000. Combined fighting sports – defined as a contest, exhibition or display which combines boxing or wrestling with one or more martial arts – are licensable as a boxing or wrestling entertainment rather than an indoor sporting event.
 - Live music: no licence permission is required for:
 - a performance of unamplified live music between 08.00 and 23.00 on any day, on any premises.
 - a performance of amplified live music between 08.00 and 23.00 on any day on premises authorised to sell alcohol for consumption on those premises, provided that the audience does not exceed 500.
 - a performance of amplified live music between 08.00 and 23.00 on any day, in a workplace that is not licensed to sell alcohol on those premises, provided that the audience does not exceed 500.
 - a performance of amplified live music between 08.00 and 23.00 on any day, in a church hall, village hall, community hall, or other similar community premises, that is not licensed by a premises licence to sell alcohol, provided that (a) the audience does not exceed 500, and (b) the organiser gets consent for the performance from a person who is responsible for the premises.
 - a performance of amplified live music between 08.00 and 23.00 on any day, at the non-residential premises of (i) a local authority, or (ii) a school, or (iii) a hospital, provided that (a) the audience does not exceed 500, and (b) the organiser gets consent for the performance on the relevant premises from: (i) the local authority concerned, or (ii) the school or (iii) the health care provider for the hospital.
 - Recorded Music: no licence permission is required for:
 - any playing of recorded music between 08.00 and 23.00 on any day on premises authorised to sell alcohol for consumption on those premises, provided that the audience does not exceed 500.
 - any playing of recorded music between 08.00 and 23.00 on any day, in a church hall, village hall, community hall, or other similar community premises, that is not licensed by a premises licence to sell alcohol, provided that (a) the audience does not exceed 500, and (b) the organiser gets consent for the performance from a person who is responsible for the premises.
 - any playing of recorded music between 08.00 and 23.00 on any day, at the non-residential premises of (i) a local authority, or (ii) a school, or (iii) a hospital, provided that (a) the audience does not exceed 500, and (b) the organiser gets consent for the

Arches 369 & 370 Helmsley Place E8 3SB
Application for a Premises Licence

Premises Description:

The application proposes a single core hours premises licence to replace the current 2 x 01:45am premises licences reference 061486 and 061401 covering Arches 369 and 370 with updated licence conditions.

The premises will operate as a central kitchen and brewery storage facility, with an accompanying restaurant and bar facility in Arches 369 and 370 with external terrace.

Proposed Licensable Activities:

	Late Night Refreshment Alcohol (on & off sales)	Opening Hours
Sunday - Thursday	08:00 – 23:00	08:00 – 23:30
Friday - Saturday	08:00 – 00:00	08:00 – 00:30

Proposed Conditions:

1. The requirement for SIA registered supervisors to be employed at the premises shall be subject to an ongoing risk assessment by the premises licence holder. Where required, SIA registered door supervisors will be employed in accordance with the risk assessment.
2. The premises shall install and maintain a comprehensive CCTV system as per the minimum requirements of the Hackney Police Licensing Team. All entry and exit points will be covered enabling frontal identification of every person entering in any light condition. The CCTV system shall continually record whilst the premises is open for licensable activities and during all times when customers remain on the premises. All recordings shall be stored for a minimum period of 31 days with date and time stamping. Viewing of recordings shall be made available immediately upon the request of Police or authorised officer throughout the preceding 31 day period.
3. A staff member from the premises who is conversant with the operation of the CCTV system shall be on the premises at all times when the premises is open. This staff member must be able to provide a Police or authorised council officer copies of recent CCTV images or data with the absolute minimum of delay when requested.
4. The licensee shall display the telephone number/email address of the Designated Premises Supervisor for use by any Responsible Authority or any person who may wish to make a complaint during the operation of the licence in a prominent external location at the premises that is easily accessible to the public.
5. There shall be a written dispersal policy in a form agreed with the Police and Licensing Authority, a copy of which shall be kept on the premises and produced to Police or an authorised officer upon request.

6. Patrons permitted to temporarily leave and then re-enter the premises, e.g. to smoke, shall not be permitted to take alcoholic drinks with them.
7. An incident log shall be kept at the premises, and made available on request to an authorised officer of the City Council or the Police, which will record the following:
 - a. all crimes reported to the venue;
 - b. all ejections of patrons;
 - c. any complaints received concerning crime and disorder;
 - d. any incidents of disorder;
 - e. all seizures of drugs or offensive weapons;
 - f. any faults in the CCTV system or searching equipment or scanning equipment;
 - g. any refusal of the sale of alcohol; and
 - h. any visit by a relevant authority or emergency service.
8. Notices shall be displayed at the exit of the premises requesting customers leaving the premises to respect the needs of local residents and businesses and leave the area quietly.
9. A Challenge 25 proof of age scheme shall be operated at the premises where the only acceptable forms of identification are recognised photographic identification cards, such as a driving licence, passport or proof of age card with the PASS Hologram.
10. No deliveries to the premises shall take place between 23.00 and 07.00 on the following day.
11. All waste shall be properly presented and placed out for collection no earlier than 30 minutes before the scheduled collection times.
12. No noise generated on the premises, or by its associated plant or equipment, shall emanate from the premises nor vibration be transmitted through the structure of the premises which gives rise to a nuisance.
13. The Licensee shall ensure that all staff are fully trained and made aware of the legal requirement of businesses to comply with their responsibility as regards the disposal of waste produced from the business premises. The procedure for handling and preparing for disposal of the waste shall be in writing and displayed in a prominent place where it can be referred to at all times by staff.
14. The Licensee shall ensure that any contract for general and recyclable waste disposal shall be appropriate in size to the amount of waste produced by the business. The Licensee shall maintain an adequate supply of waste receptacles provided by his registered waste carrier (refuse sacks or commercial waste bins) in order to ensure all refuse emanating from the business is always presented for collection by his waste carrier and shall not use any plain black or unidentifiable refuse sacks or any other unidentifiable or unmarked waste receptacles.
15. The Licensee's premises are situated in an area within which refuse may only be left on the public highway at certain times (time bands). If the Licensee's waste carrier cannot or does not comply by collecting the refuse within an hour after the close of any time band imposed by the waste authority, the Licensee must remove the refuse from the public highway and/or keep it within the premises until such time as his/her waste carrier arrives to collect the refuse.

16. The Licensee shall instruct members of staff to make regular checks of the area immediately outside the premises and remove any litter, bottles and glasses emanating from the premises. A final check should be made at close of business.
17. The Licensee shall provide a safe receptacle for cigarette ends to be placed outside for the use of customers, such receptacle being carefully placed so as not to cause an obstruction or trip.
18. The current trade waste agreement/duty of care waste transfer document shall be conspicuously displayed and maintained in the window of the premises where it can be conveniently seen and read. This should remain unobstructed at all times and should clearly identify:-

the name of the registered waste carrier

the date of commencement of trade waste contract the date of expiry of trade waste contract

the days and times of collection

the type of waste including the European Waste Code

Furniture layouts indicative only

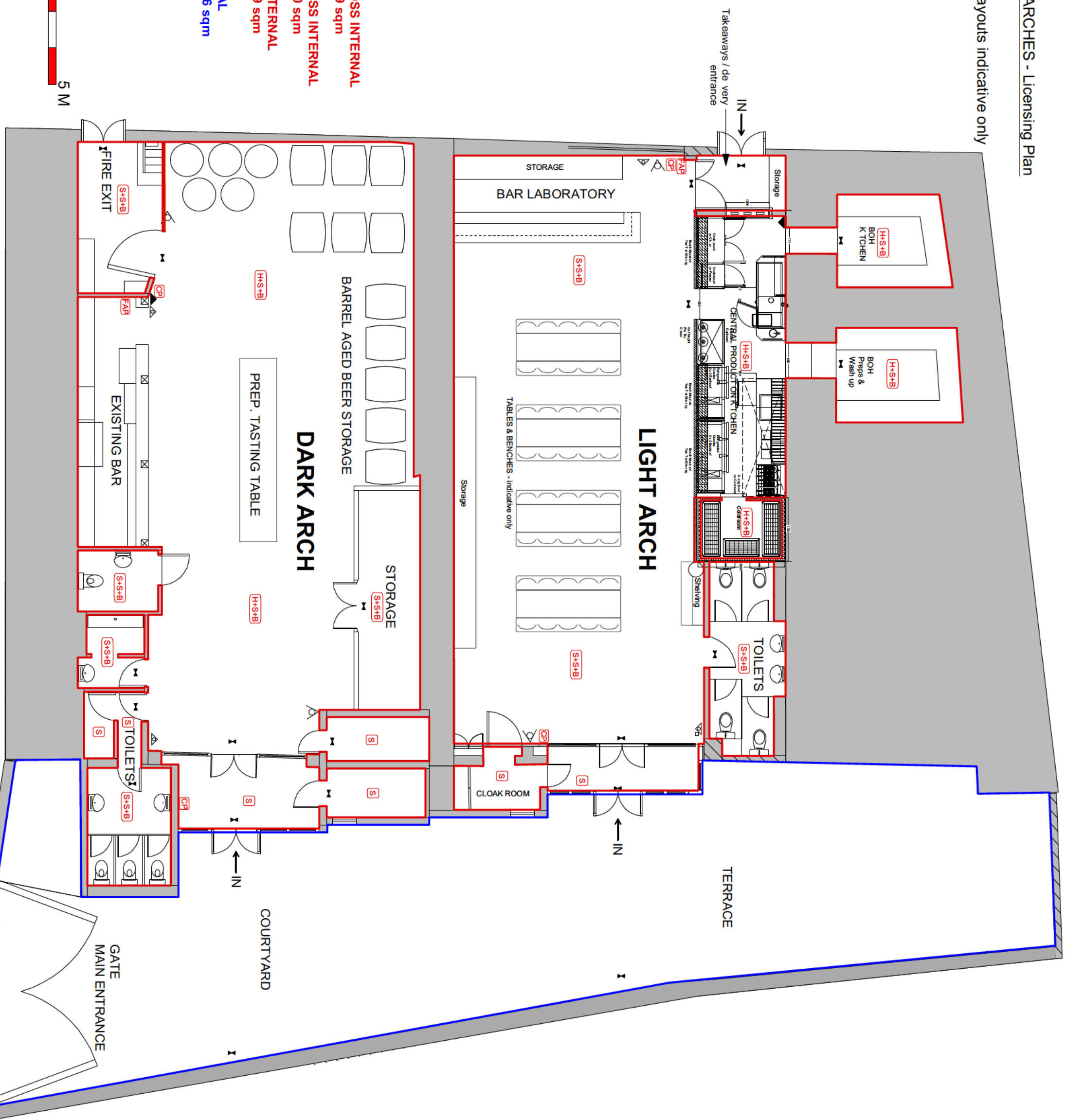

LIGHT ARCH GROSS INTERNAL FLOOR AREA: 169 sqm
DARK ARCH GROSS INTERNAL FLOOR AREA: 170 sqm
TOTAL GROSS INTERNAL FLOOR AREA: 339 sqm
GROSS EXTERNAL FLOOR AREA: 166 sqm

Notes & Disclaimer
 Please refer to the following notes:
 These drawings are design documents and are based on the information provided by the client. The client is responsible for ensuring that the information provided is accurate and complete. The contractor is responsible for ensuring that the drawings are followed as shown. The contractor is not responsible for any errors or omissions in the drawings. The contractor is not responsible for any damage or injury to persons or property resulting from the use of the drawings. The contractor is not responsible for any legal action taken against the contractor or any other party as a result of the use of the drawings.

- Proposed Interior License Area
- Proposed Exterior License Area
- Area Covered by Escape Lighting
- Carbon Dioxide Fire Extinguisher
- FD30 Fire door 30 mins
- CCTV
- Foam Fire Extinguisher
- Fire Alarm control panel
- Fire Alarm control panel
- Optical Smoke, Sounder & Beacon
- Heat, Sounder & Beacon
- Manual Call Point
- Optical Smoke Heat Detector
- Heat Detector
- Interface

No	Date	By	Revision Notes

RUN FOR THE HILLS | MEMBER **ABO**
 15 Doug as Road
 London NW6 7RN
 www.runforthehills.com
 sayhe_o@runforthehills.com

Project
 KRICKET LONDON FIELDS
 Hackney

Drawing description
 LIGHT & DARK ARCHES - Licensing Plan

Scale	Date	Drawn by	Reviewed by
1:100	20/05/2021	FB	-
Contract No	Sheet No	Project ID	Revision
	01.02.01		

APPENDIX B1

RESPONSIBLE AUTHORITY REPRESENTATION: APPLICATION UNDER THE LICENSING ACT 2003

RESPONSIBLE AUTHORITY DETAILS

NAME OF AUTHORITY	Metropolitan Police service
ADDRESS OF AUTHORITY	Licensing Unit, Stoke Newington Police Station 33 Stoke Newington High Street London N16 8DS
CONTACT NAME	PC 1505CE Dave ATKINS
TELEPHONE NUMBER	07796 183078
E-MAIL ADDRESS	hackneylicensing@met.police.uk

APPLICATION PREMISES

NAME & ADDRESS OF PREMISES	Arches 369+370 Helmsley Place London E8 3SB
NAME OF PREMISES USER	Kricket Delivery Limited

COMMENTS

I make the following relevant representations in relation to the above application to vary the Premises Licence at the above address.

- 1) The prevention of crime and disorder ◆
- 2) Public safety
- 3) The prevention of public nuisance ◆
- 4) The protection of children from harm

Representations (which include comments and/or objections) in relation to:

Police submit the following representations for the new premises licence at Arches 369+370 Helmsley Place. The venue is one of a number of arches that already benefit from premises licences that allow for the consumption of alcohol on the premises.

These venues already operate under two separate licences and this application seeks to replace these with one single licence whilst reducing the current hours to sit in line with the core hours as laid out in the London Borough of Hackneys statement of Licensing Policy for licensable activity.

It should be noted that although there are already a number of existing premises licences in the immediate vicinity they are in the midst of constructing eight three bedroom flats opposite the venue meaning that in addition to the existing residents in the area there will be the potential for 8 further families with young children

There has been a history of resident complaints at this premises involving Dispersal in the street, Noise complaints and overcrowding in the premises when both arches have been in use

In respect of this application Police would ask the following of the applicant:

- What will the capacities be of each arch and the external courtyard?
- Will the venue be hosting events? Will there be separate events held in each arch simultaneously

Police are concerned that without sufficient measures in place the granting of this licence will undermine the licensing objectives namely crime and disorder and public nuisance.

Police look forward to hearing from the applicant to discuss this application further

The above representations are supported by the following evidence and information.

Are there any actions or measures that could be taken to allay concerns or objections? If so, please explain.

Signed PC 1505CE ATKINS (By E-mail)
Name (printed)

APPENDIX B2

RESPONSIBLE AUTHORITY REPRESENTATION: APPLICATION UNDER THE LICENSING ACT 2003

RESPONSIBLE AUTHORITY DETAILS

NAME OF AUTHORITY	Licensing Authority
ADDRESS OF AUTHORITY	Licensing Service Hackney Service Centre 1 Hillman Street London E8 1DY
CONTACT NAME	David Tuitt
TELEPHONE NUMBER	020 8356 4942
E-MAIL ADDRESS	david.tuitt@hackney.gov.uk

APPLICATION PREMISES

Premises	Kricket Delivery 369 & 370 Helmsley Place London E8 3SB
Applicant	Kricket Delivery Limited

COMMENTS

I make the following relevant representations in relation to the above application for a premises licence at the above address.

- 1) the prevention of crime and disorder
- 2) public safety
- 3) the prevention of public nuisance **x**
- 4) the protection of children from harm

Representations (which include comments and/or objections) in relation to:

I write in relation to the application submitted for a premises licence. The proposal appears to be seeking to consolidate two existing licences into one. However, the proposal could have a negative impact on the prevention of public nuisance bearing in mind the complaints received when the premises operated as "Brewhouse". It is noted that the proposed hours are significantly reduced from the current licences, but it would also be helpful if the applicant could clarify, amongst other things, the following:

- Overall capacity (currently 500)
- Hours of use of the external areas and if this could be limited to 22:00.
- Whether alcohol sold for consumption on the premises will be ancillary to seated table meals.

The above representations are supported by the following evidence and information.

The Licensing Act 2003, s182 Guidance issued by the Home Office, Statement of Licensing Policy

Are there any actions or measures that could be taken to allay concerns or objections? If so, please explain.

Discussion with the applicant and clarification in relation to matters highlighted above

Name: **David Tuitt (Business Regulation Team Leader) - Licensing and Technical Support**

13 July 2021

APPENDIX C

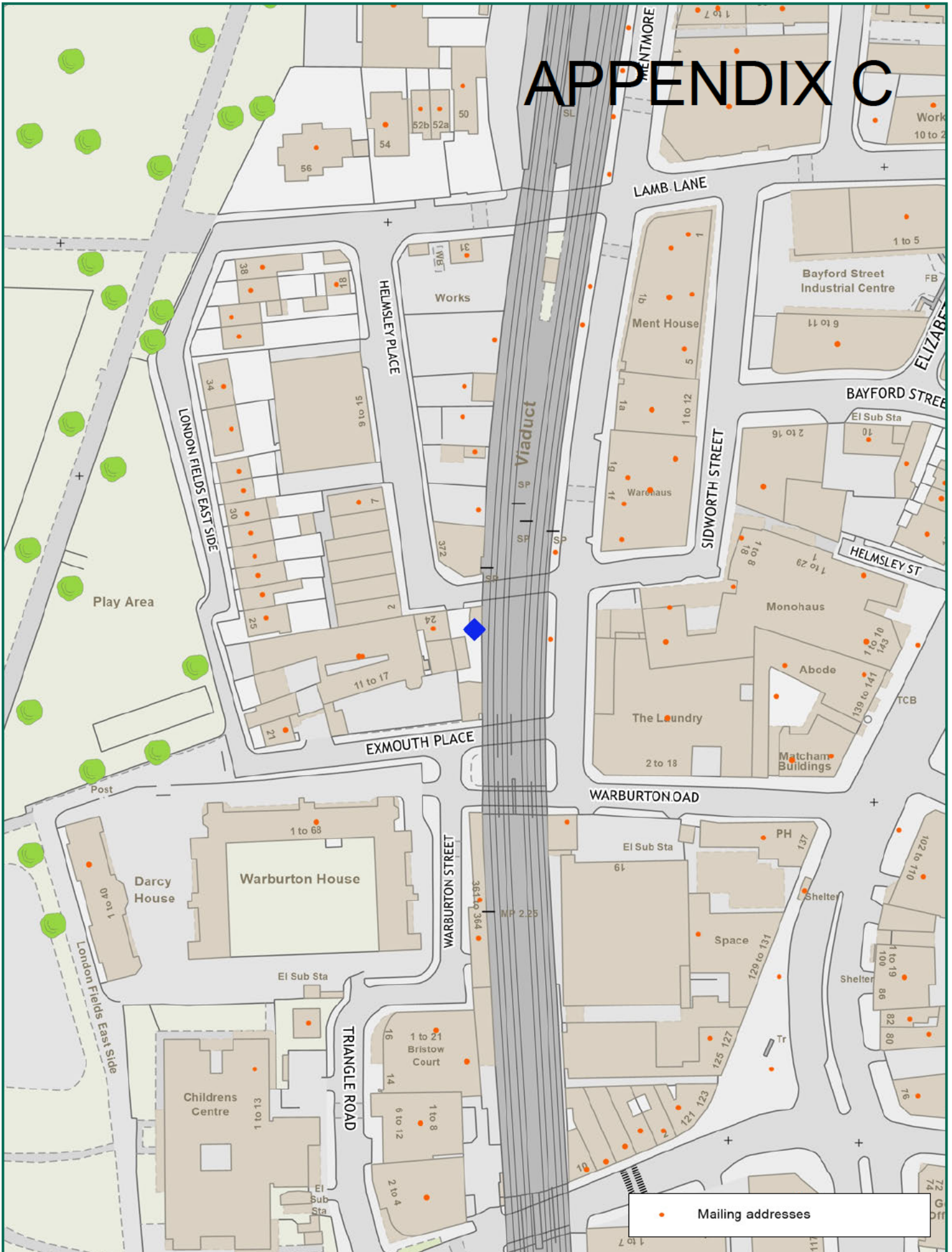

Scale: 1:1250 at A4

369-370 Helmsley Place



Ref:
Thursday, September 2, 2021

Produced by: unspecified
email:

please specify copyright statement